

OVERSEAS PROJECTS

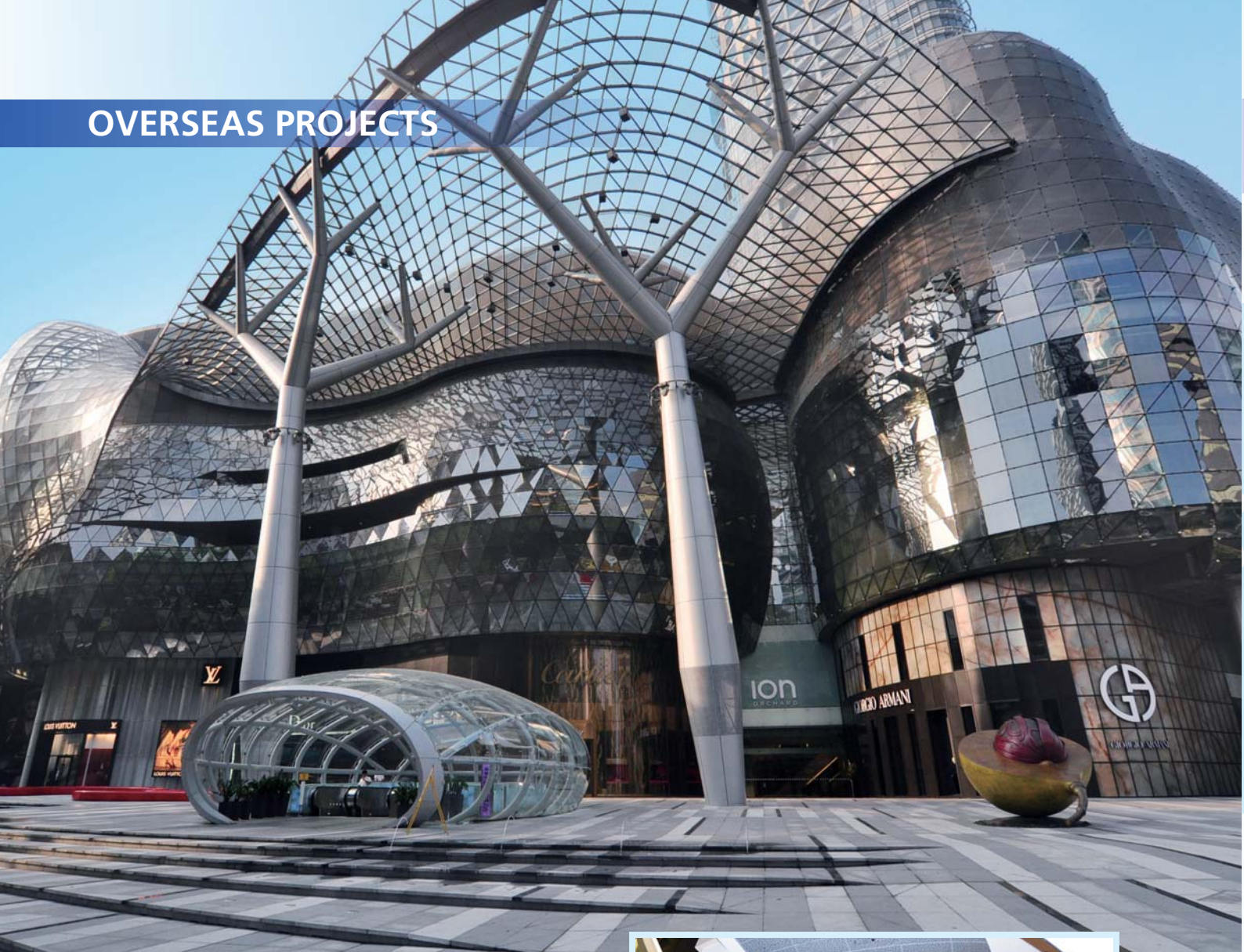

ION Orchard and the Orchard Residences (Singapore)

On Orchard Road, home to Singapore's most prestigious high-end shopping area, a new super high-rise building has risen. With a height of 218m and 56 stories above ground, the building is comprised of luxury condominiums and a shopping mall that extends from the 4th basement level to the 9th floor. And there is a direct link to Orchard MRT Station, the most heavily trafficked site on Orchard Road.

The shopping mall is sheathed in a metallic, curvilinear glass façade. When night falls, the exterior transforms into a light-covered media screen. Owing to its luxuriousness and originality, the development has already become an Orchard Road landmark that is gaining popularity around the world.

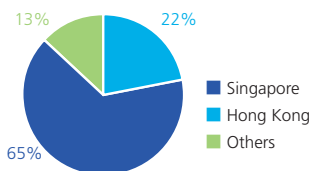
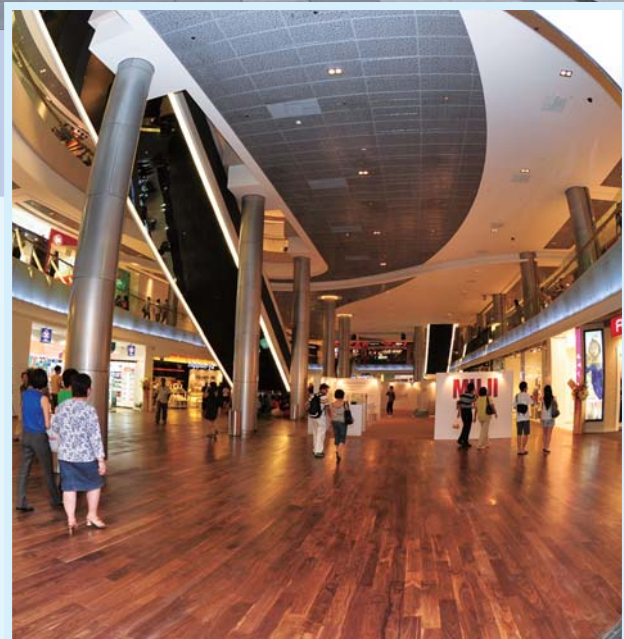

Overseas Projects: Fiscal 2009 Orders Received by Sector [Non-Consolidated]

We received orders for a shield construction project and a cruise terminal, both large-scale civil engineering projects that are part of Hong Kong's 10 major infrastructure projects. As a result, the share of orders received from Hong Kong grew considerably.

Hong Kong Institute of Vocational Education Lee Wai Lee Campus (Hong Kong)

Established in 1969, this venerable vocational training school sends 50,000 of its students into society each year. The completed facility, conceived of by a prominent French design firm (Coldefy & Associes Architectes Urbanistes), boasts a novel design consisting of four towers (56m in height, 11 stories).

The construction, particularly the steel construction, demanded execution with a high degree of difficulty, but we managed to earn high marks from both the client and consultants. The Company previously constructed an educational facility for the school's department of information systems.



Rendering of the completed Kai Tak Cruise Terminal (Hong Kong)



Rendering of the completed International Cruise Terminal (Singapore)

Construction of Representative Cruise Terminals for Asia in Two Countries

The Company is currently constructing cruise terminals in the two major Asian hubs of Hong Kong and Singapore to accommodate increasing demand for cruises and the growing size of passenger vessels.

In Hong Kong, we are constructing the Kai Tak Cruise Terminal. Designated as one of 10 major infrastructure projects and situated within a redevelopment area at the former Kai Tak Airport, the terminal will consist of two berths that will accommodate the world's largest luxury cruise ships.

In Singapore's Marina South district, which is undergoing continuing redevelopment as a new business area, we are proceeding with construction of the International Cruise Terminal. This facility will also allow the berthing of two large-scale cruise vessels.

Solar Power System in Abu Dhabi (UAE)

We completed a solar power system demonstration plant in Abu Dhabi, the capital of the United Arab Emirates. It is expected to provide a source of renewable energy that will allow for a reduction in greenhouse gases (CO₂), which are said to significantly influence global warming.

Abu Dhabi Future Energy Company (commonly known as Masdar) and Japan's Cosmo Oil Co., Ltd. are joint partners in the project, Mitsui Engineering & Shipbuilding Co., Ltd. is the EPC contractor, and our Company is engaged in construction cooperation.

This futuristic, unique-looking plant uses numerous primary mirrors (heliostats equipped with an automated guidance system) arrayed around the periphery that reflect the sun's rays, which are then concentrated onto large secondary mirrors on the center reflector. The secondary mirrors then reflect the rays again onto a solar furnace directly below, which uses high temperatures to drive a steam turbine and generate energy.

This solar power system demonstration plant will be used to conduct various performance evaluation tests, and the future construction of a large-scale plant of this type will be considered.

